

BENJAMIN OBDYKE
roof & wall products

Roof Protection System

a guide for high performance exteriors

CONTENTS

Roof Assembly System	4 - 5
VaporDry® SA	6 - 7
Cedar Breather®	8 - 9
Rapid Ridge® 7	10 - 11
Flashing & Accessories	12
Why a Systems Approach?	13
Benjamin Obdyke	14 - 15

ROOF PROTECTION SYSTEM

VaporDry® SA Cedar Breather® Accessories

There's nothing quite like the aesthetic of an authentic, cedar roof. Building practice and the composition of cedar itself has changed dramatically since it was first installed on a roof. In spite of these changes, there remains an opportunity to install a beautiful cedar roof that will stand the test of time.

The wood roofing protection system marries three key products: Cedar Breather® Roofing Ventilation Mat, VaporDry® SA, and Rapid Ridge® 7. Together, these products provide a ventilated space behind the cedar shakes or shingles, allowing the cedar to dry and live its full, beautiful life.



removes
bulk water



easy
install



air
tightness



maximum
protection



nail
sealability



vapor
permeable

25 Year System Warranty

Premium tri-laminate self-adhered roofing underlayment

Ideal combination with Cedar Breather®

High temperature resistance compatible with all roofing types

Vapor permeable for high performance roof assemblies

Approved for use in ice & water barrier applications

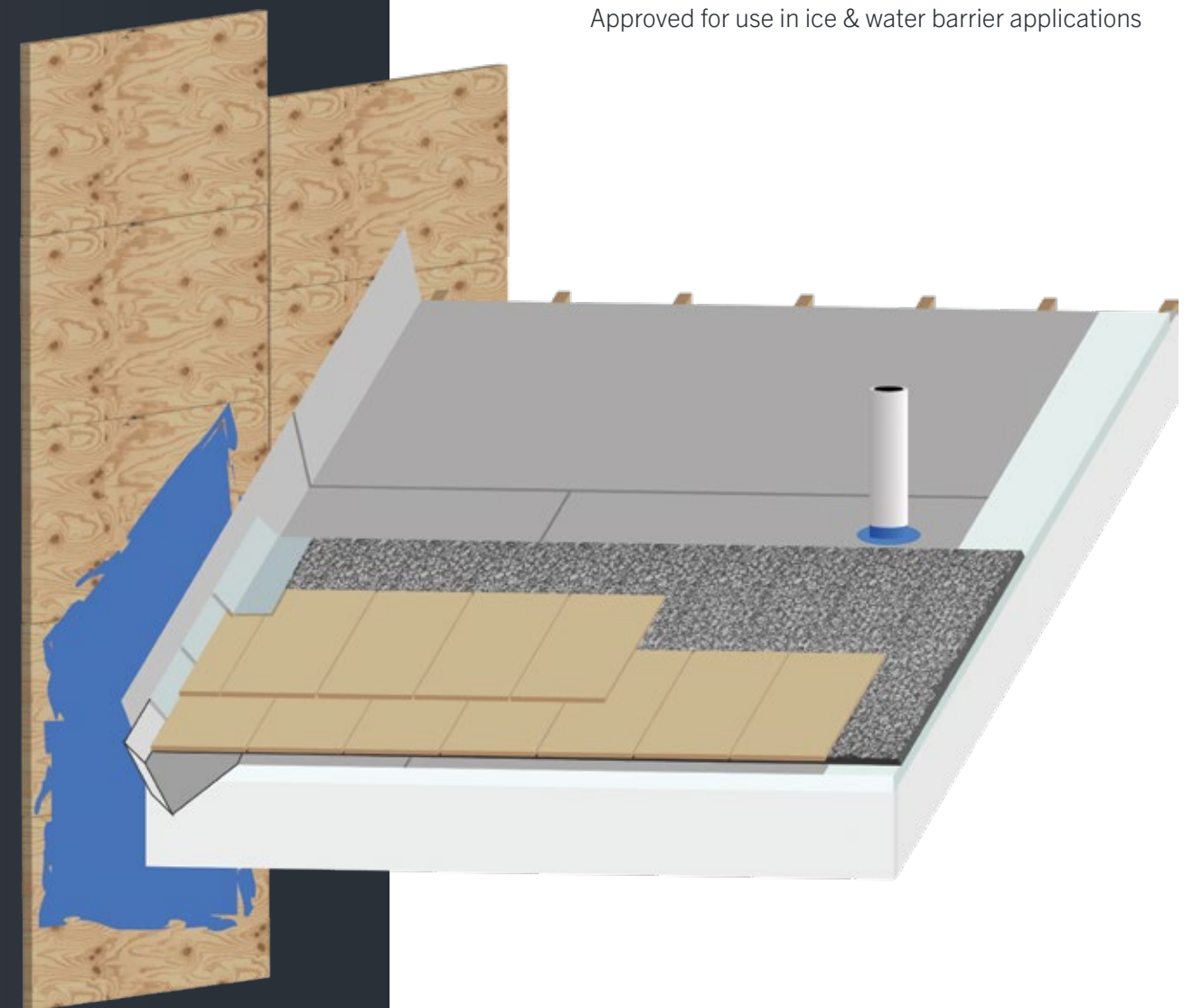

VAPORDRY® SA

VAPOR PERMEABLE SELF-ADHERED ROOF UNDERLAYMENT

VaporDry® SA is one of the only fully self-adhered, vapor permeable underlayments. The continuous acrylic adhesive provides enhanced sealability, while reducing the potential of damage due to moisture build up. VaporDry® SA helps to create a high-performance roof assembly when paired with Cedar Breather® Roof Ventilation Mat and Rapid Ridge® 7.

*Self-Adhered roofing
membrane with
vapor permeability*

*Continuous acrylic
adhesive is
repositionable*

*Approved for use with
all roofing types with
a pitch of 3:12 or
greater*

*Ideal underlayment
in combination with
Cedar Breather*

WIDTH

4.75 ft (1.45 m)

LENGTH

80 ft. (24.38 m)

MAXIMUM UV EXPOSURE

120 days

COMPOSITION

polypropylene tri-laminate

VAPOR PERMEABILITY

14 perms ASTM E96(a)

ADHESION

continuous acrylic

GROSS COVERAGE

380 sq. ft./roll

ICE BARRIER TESTING - AC48

pass

HIGH SERVICE TEMPERATURE

250°F



CEDAR BREATHER®

VENTILATED ROOFING MAT

Are you looking for a top-tier ventilated roofing mat for wood and metal roofing systems? You've found it. Our Cedar Breather® product is known for protecting the beauty and life of wood roofing by providing a space for continuous airflow between the solid roof deck and shingles or shakes. It is also a great solution to providing an airflow space under metal roofs.

For optimum performance, use Cedar Breather® with Rapid Ridge® 7 ridge vent. This underlayment is fire-resistant, easy to install, and helps get rid of any excess moisture.

3D matrix allows for continuous airflow

Quick and easy installation without any special tools

Protects beauty and life of wood roofing by eliminating excess moisture

Can also be used in metal applications as a sound mat

- WIDTH
3.25 ft (1 m)
- LENGTH
61.5 ft (18.75 m)
- COVERAGE
200 sq. ft.
- FIRE RATING
Class A
- WEIGHT
9.7 lbs. per roll
- COMPRESSION & THICKNESS
zero lbs per sq. ft .27 in
100 lbs per sq. ft .26 in
200 lbs per sq. ft .25 in



RAPID RIDGE® 7

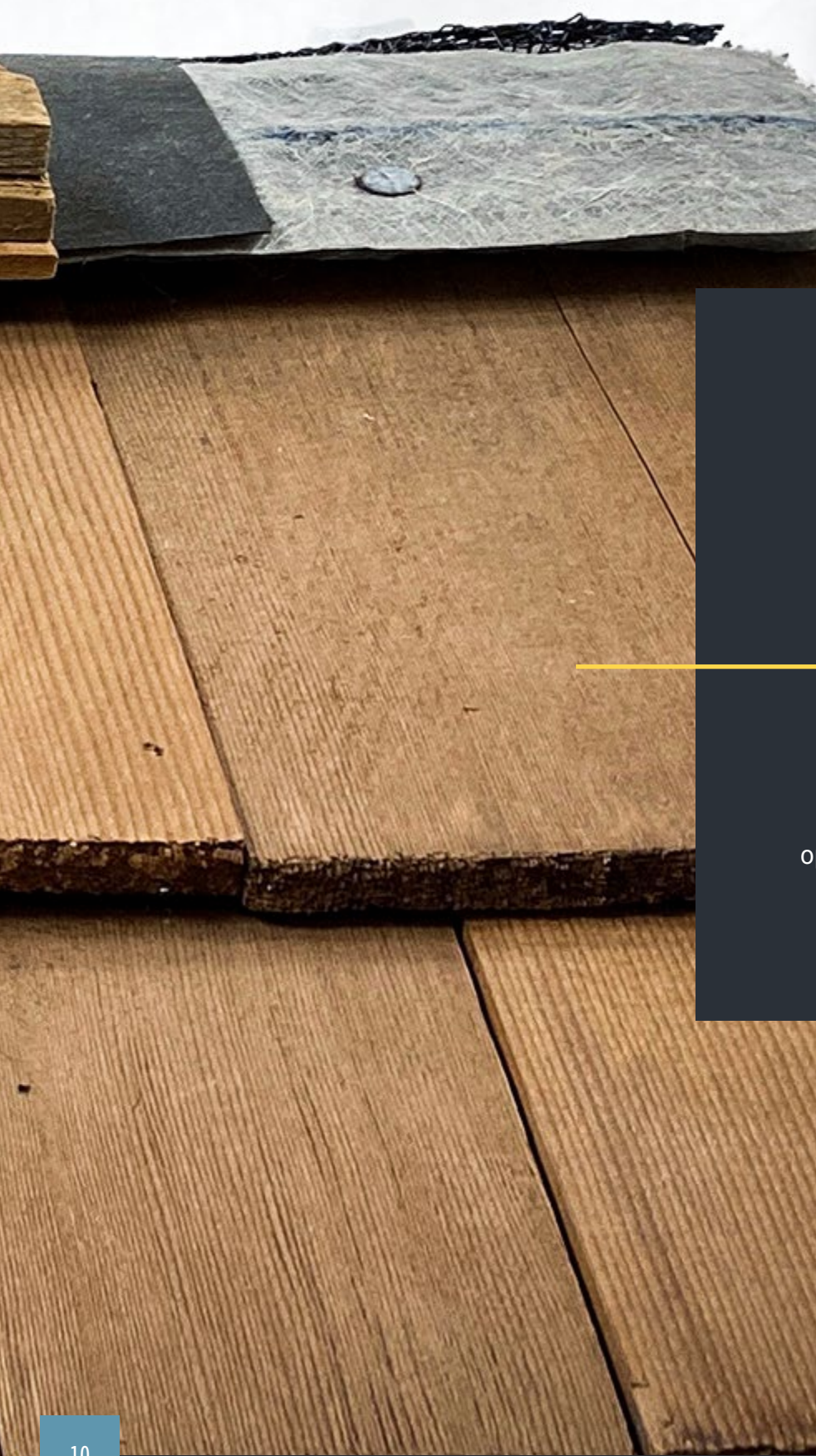

**CEDAR
SHINGLE
RIDGE VENT**

Rapid Ridge® 7 is specifically designed for use with narrow hip and ridge shingles, cedar and slate. For optimum performance in wood roofing applications use Rapid Ridge® 7 with Cedar Breather®

Made specifically for narrow hip & ridge shingles (cedar & slate)

Low-profile design provides sleek & almost invisible protection

Compression resistant design

Wing tip design prevents shingles from folding over ridge vent

- WIDTH
7 inches
- LENGTH
20 feet
- THICKNESS
5/8 inch
- NET FREE AREA
12.5 in²/lin. ft.



COMPLETE THE SYSTEM

flashing + accessories

HydroFlash® UV+ | Self-Adhered Flashing



WIDTHS	2.3 in. (60mm), 4 in. (100mm), 6 in. (150mm), 9 in. (230mm)
LENGTH PER ROLL	82 ft. (25m)
ADHESIVE	acrylic
MAX. UV EXPOSURE	365 days before siding installation
TEMPERATURE RANGE	install down to 25°F, store above 40°F
VAPOR PERMEABILITY	4 perms

HydroFlash® LA | Liquid Applied Flashing



PACKAGING	20 oz. sausages/12 per carton 10 oz. cartridges/24 per carton
TYPICAL COVERAGE	8 - 10 sq. ft. per sausage 3 - 5 sq. ft. per cartridge
CURED THICKNESS	20 - 40 wet mils
COMPOUND TECHNOLOGY	STPU - Silyl Terminated Polyurethane
TACK FREE TIME	2 - 3 hours
CURE TIME	6 hours
INSTALL TEMP.	25° F - 100° F
EXPOSURE	180 days
VAPOR PERMEABILITY	3 - 6 perms (20 - 40 wet mils)

code minimum



easy to install



removes bulk water



dries behind roofing



air tightness



nail sealable



max. uv protection



maxium protection



The evolution of building science now requires us to look at the building envelope as a whole — and for good reason, too. The drive for energy efficiency and tighter homes created new issues with moisture as wall cavities failed to dry out, highlighting the importance of considering how each design and product element impacts the performance of the others. The overall building system should factor a culmination of products that work together to enhance one another to maximize performance, durability, and value of a building structure. That’s why at Benjamin Obdyke, we not only develop these products, but we also keep in mind how they best combine into an ideal system.

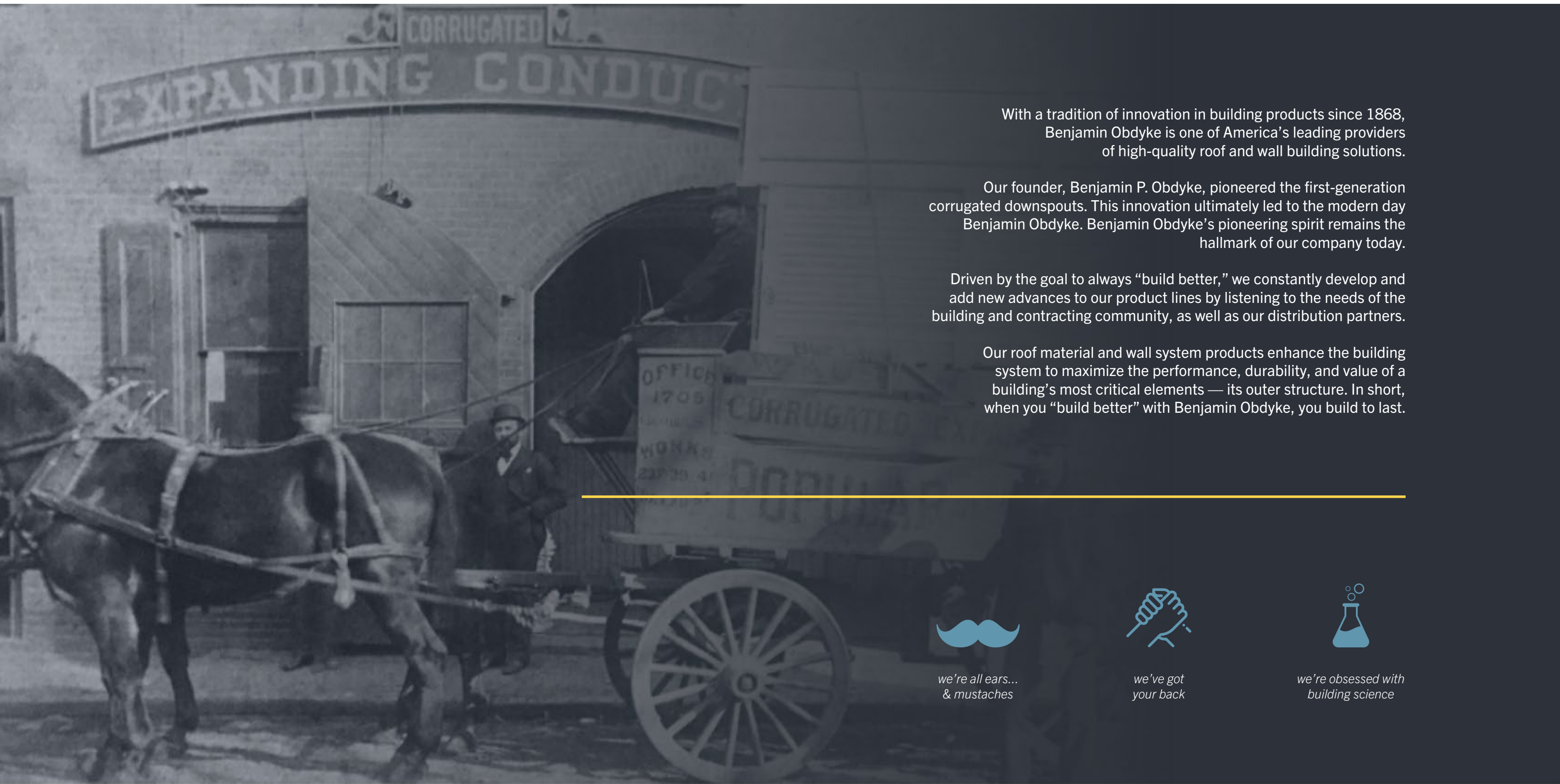

With a tradition of innovation in building products since 1868, Benjamin Obdyke is one of America's leading providers of high-quality roof and wall building solutions.

Our founder, Benjamin P. Obdyke, pioneered the first-generation corrugated downspouts. This innovation ultimately led to the modern day Benjamin Obdyke. Benjamin Obdyke's pioneering spirit remains the hallmark of our company today.

Driven by the goal to always "build better," we constantly develop and add new advances to our product lines by listening to the needs of the building and contracting community, as well as our distribution partners.

Our roof material and wall system products enhance the building system to maximize the performance, durability, and value of a building's most critical elements — its outer structure. In short, when you "build better" with Benjamin Obdyke, you build to last.



*we're all ears...
& mustaches*



*we've got
your back*



*we're obsessed with
building science*

CHECK OUT WALL PROTECTION SYSTEMS FROM BENJAMIN OBDYKE

For Technical Questions: 800.523.5261 or techsupport@obdyke.com

400 Babylon Rd. Suite A
Horsham, PA 19044

1.800.523.5261

©2025 Benjamin Obdyke Incorporated: VaporDry®, Cedar Breather®, Rapid Ridge®, Slicker®, FlatWrap®, HydroGap®, InvisiWrap®, HydroFlash®, and HydroCorner® are registered trademarks of Benjamin Obdyke Incorporated. REV 4/24/2025

