

invisiwrap® sa

hydroflash® uv+

accessories

# INVISIWRAP® SA

## installation instructions





# UV-PROTECTED RAINSCREEN SYSTEM INSTALLATION INSTRUCTIONS

invisiwrap® sa

hydroflash® uv+

accessories

## PREINSTALLATION CONSIDERATIONS

**When InvisiWrap SA is used in an Open Joint Cladding (OJC) application, the following are required for the 25 year system warranty:**

All penetrations including mechanicals, windows, and doors are properly flashed using HydroFlash UV+ flashing tape.

**When a minimum 1/4 inch rainscreen is installed between InvisiWrap SA and the cladding, open joint cladding boards can be installed up to a maximum of a 2 inch joint.**

If the cladding is installed directly to InvisiWrap SA, the joints between cladding boards must not be greater than a 1/4 inch joint.

**InvisiWrap SA is engineered to resist the ultraviolet radiation (UV) from the sun in an OJC application and complies with all ASTM standards (AC 308) to be used as the primary water and air control layer (water resistant barrier or WRB), when detailed in accordance with published installation guidelines.**

**Identify all control layers in the building envelope (UV, Water, Air, Vapor, and Thermal) and verify continuity at all penetrations (windows, doors, outlets, mechanicals, etc.) and transitions (foundation to framing, wall to ceiling, wall to roof, etc.)**

**InvisiWrap SA is always the primary UV CONTROL LAYER for Open Joint Cladding assemblies.**

**Given the extreme conditions in an OJC assembly, more care is needed in design and application compared to a conventional WRB in a closed cladding assembly. InvisiWrap SA can be seen between the cladding pieces and should be installed without wrinkles.**

## VIRTUAL JOBSITE VISIT

Project specific installation training and window mockups are recommended to verify proper details and reduce the learning curve for installers and design professionals. Please contact us at [techsupport@obdyke.com](mailto:techsupport@obdyke.com), or fill out the request form on our website,

**OR SCAN THE QR CODE HERE.**

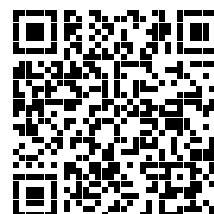

# UV-PROTECTED RAINSCREEN SYSTEM INSTALLATION INSTRUCTIONS

invisiwrap® sa

hydroflash® uv+

accessories

## INVISIWRAP SA INSTALLATION & LAYOUT

### BEGINNING COURSES

The first course of InvisiWrap SA should extend a minimum of 2 inches over the sill plate.

Using a chalk line, establish a “control line” to use as a guide for the top edge of the first courses of InvisiWrap® SA. Follow this control line as you install the first course to minimize wrinkles and ensure maximum contact with the sheathing.

Starting from the upper corner of the top half of the split release liner, peel 24 inches of the liner to expose the adhesive. Place the exposed adhesive corner to the edge of the “control line” to install the first course. OPTION: you may fasten the exposed corner with a staple or cap fastener to hold in place as you continue with the next step.

Once the corner is firmly in place, pull the rest of the top half of the release liner at a 45° angle as you work to unroll the wrap along the wall. Verify alignment and begin to smooth starting from the center of InvisiWrap SA and work to the edges. Adhesive can be repositioned on the sheathing to verify maximum contact and reduce wrinkles and air pockets

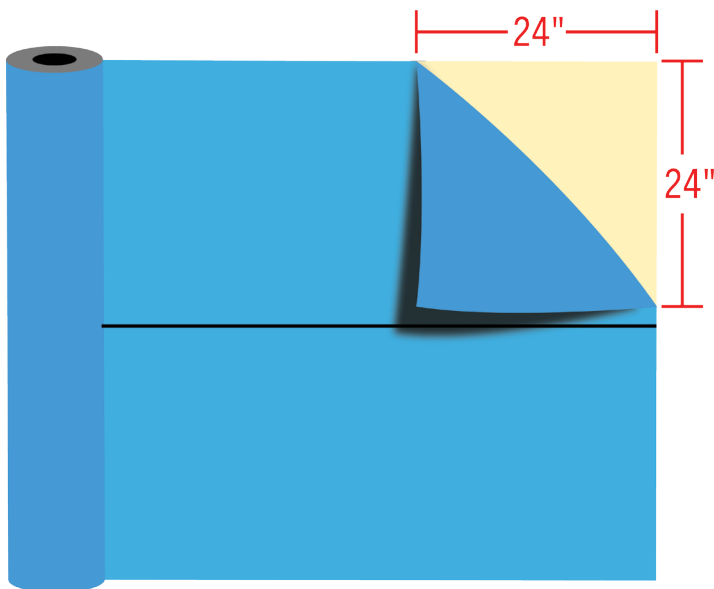

BACK OF InvisiWrap SA

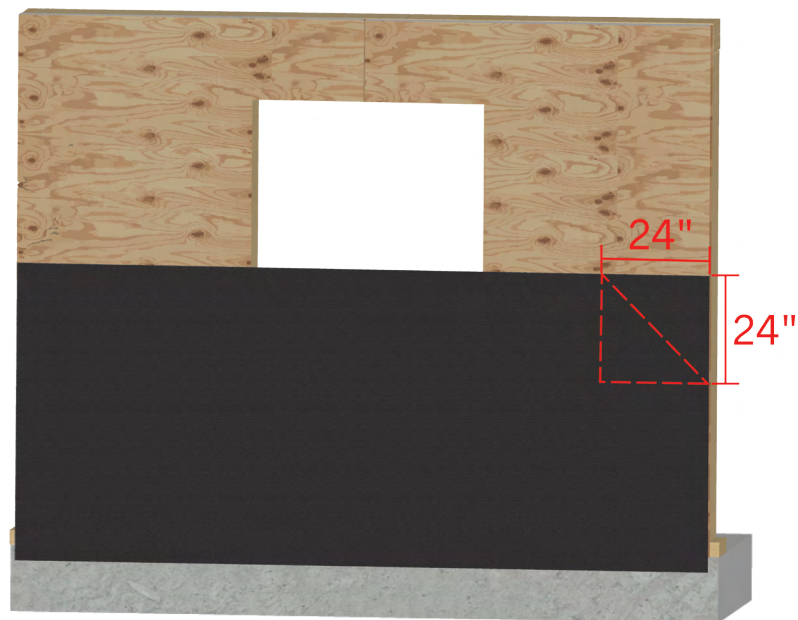

# UV-PROTECTED RAINSCREEN SYSTEM INSTALLATION INSTRUCTIONS

invisiwrap® sa

hydroflash® uv+

accessories

## INVISIWRAP SA LAYOUT & INSTALLATION

### HOUSEWRAP LAYOUT/INSTALLATION

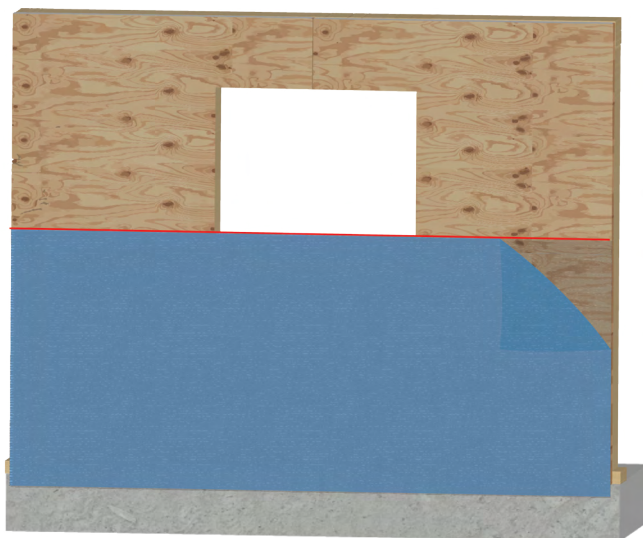

Once the course is in place, use a j-roller, floor roller, floor squeegee, firm push broom, or other application tool to apply firm, even pressure to fully adhere to the wrap to the sheathing.

Repeat the same steps for consecutive courses, shingling over as you work up the wall. Overlap requirements are as follows: horizontal overlaps 4 inches, vertical overlaps 6 inches, and 12 inches inside or around corners.

Prevent damage to the black coating on the face of the product by using ladder mitts.

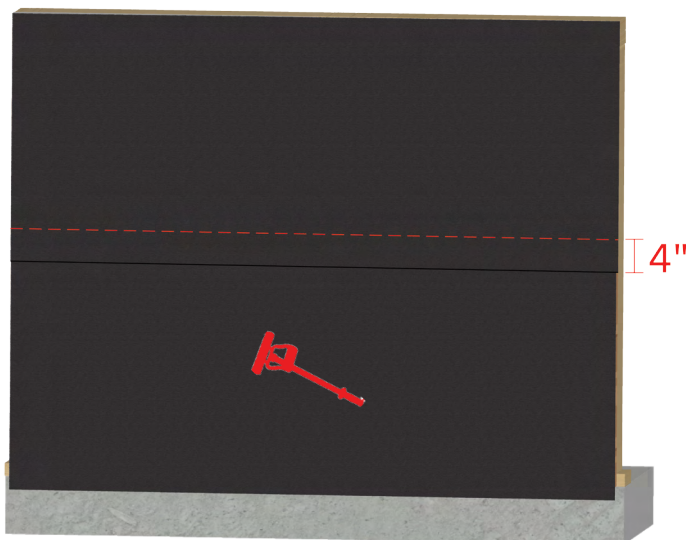

# UV-PROTECTED RAINSCREEN SYSTEM INSTALLATION INSTRUCTIONS

invisiwrap® sa

hydroflash® uv+

accessories

## BATTEN UV INSTALLATION & LAYOUT

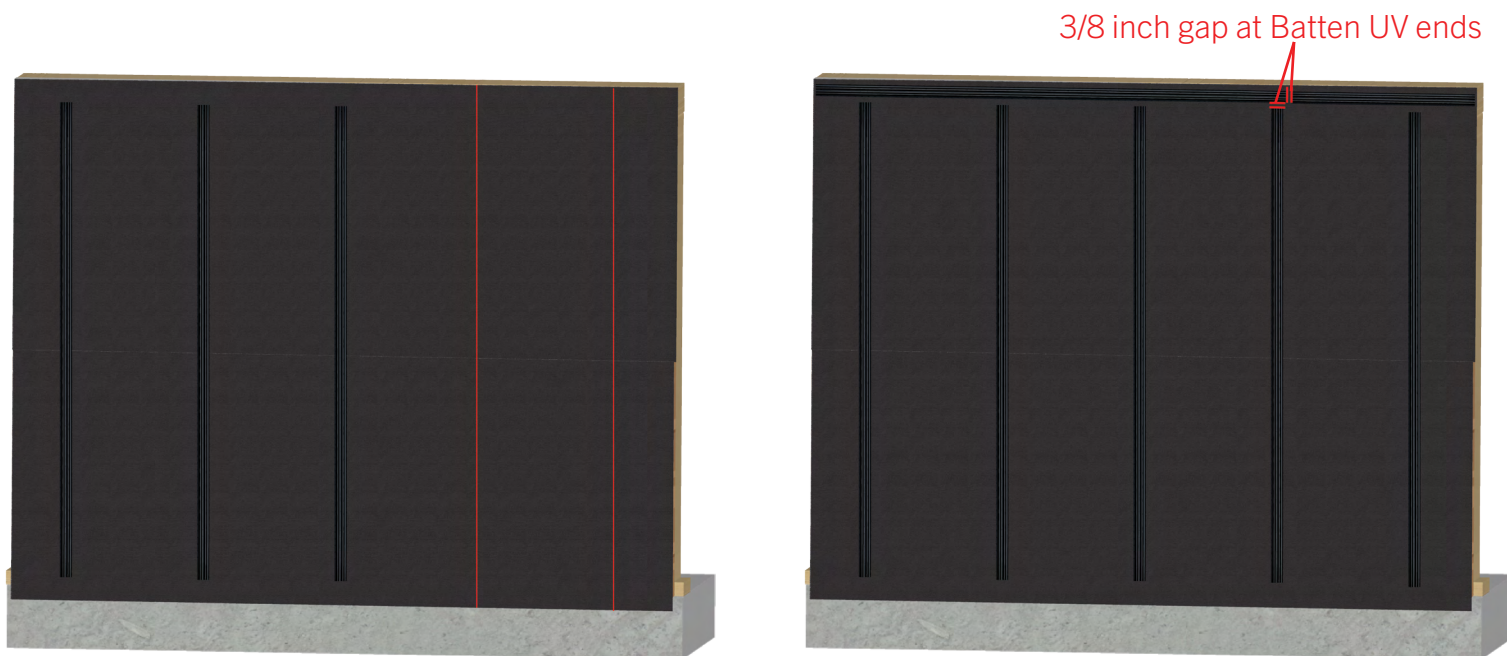

### BATTEN UV INSTALLATION

Apply vertical chalk lines every 16 inches on-center at the stud locations for furring strip/Batten UV layout.

Install Batten UV vertically or horizontally, at 16 inches on center, or diagonally, at 12 inches on center, over InvisiWrap SA - making sure that the fasteners are aligned with the stud locations.

Install 1 1/4 inch roofing nails, or other exterior fasteners using the slotted holes. Minimal fasteners are needed to hold the batten in place until siding is installed. Do not overdrive fasteners to allow expansion prior to cladding installation.

Allow a 3/8 inch space at the end of each batten to allow for expansion.

Battens must be installed behind corner trim and vertical window trim, and can be installed around the perimeter.

Install siding through Batten UV and secured to the structure's framing. Make sure to install siding per manufacturer's instructions.



# UV-PROTECTED RAINSCREEN SYSTEM INSTALLATION INSTRUCTIONS

invisiwrap® sa

hydroflash® uv+

accessories

## INVISIWRAP SA WINDOW ASSEMBLY

### “Fold-In” Window Installation

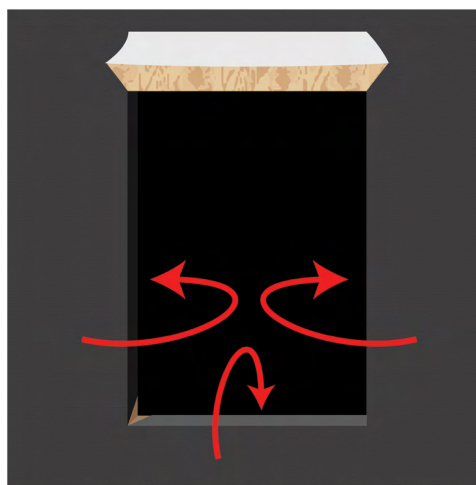
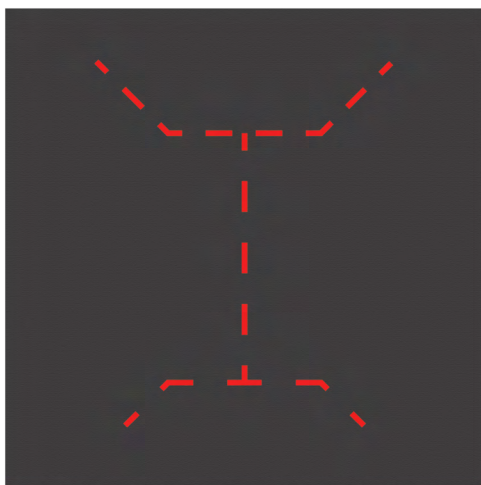

When wrapping the structure in InvisiWrap SA, avoid rolling/applying pressure to the top of windows and doors, this will ensure the proper shingle lapping of self-adhered flashing tape

At each window opening, cut an “I” shape into the housewrap. Cut housewrap above the top corners 45 degrees away from the window opening to account for flashing width.

Fold side flaps into rough opening. Cut and apply pressure allowing the adhesive to stick to the jambs.

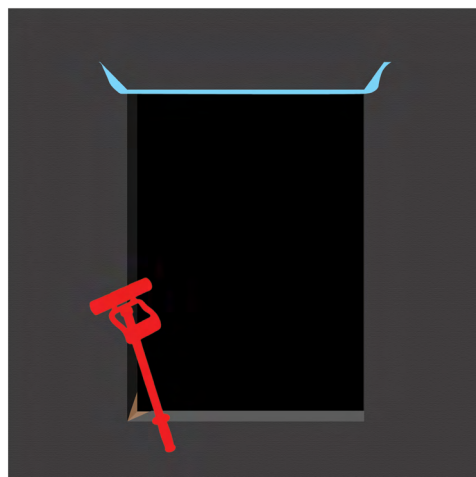

Fold up top trapezoid shape “flap” and stick a strip of the adhesive backer underneath (shiny side to the adhesive), keeping the flap from sticking to the sheathing

# UV-PROTECTED RAINSCREEN SYSTEM INSTALLATION INSTRUCTIONS

invisiwrap® sa

hydroflash® uv+

accessories

## INVISIWRAP SA WINDOW ASSEMBLY

### “Fold-In” Window Installation

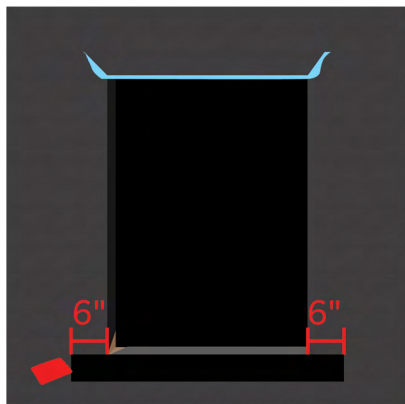

Using a roller or hand applicator, apply HydroFlash® UV + to the exterior of the sill, extending 6" past each jamb.

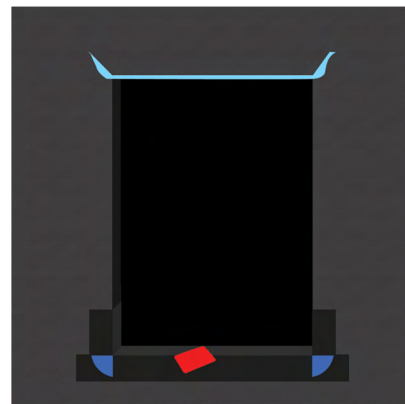

## WINDOW SILL DETAILS

### Bow tie detail

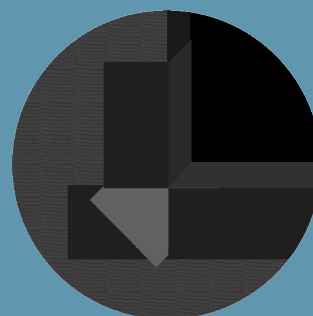
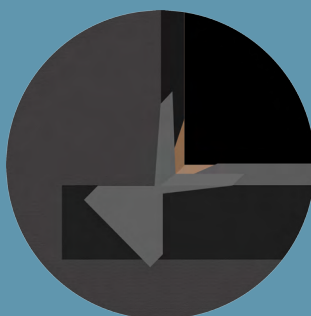
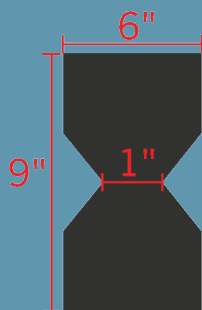

- (optional) Install sloped sill or back dam (optimal slope .25"), except when using approved pre-manufactured sill pan.
- To properly flash the sill, cut and install corner patch flashing or use HydroCorners.
- Install HydroFlash UV+ 9" to extend at least 6 inches up the side of each jamb inside window opening.
- To use 6" HydroFlash UV+ at the sill, two pieces must be used: one piece flush with the sill edge; and the other folded into the sill. All flashing should be installed using firm pressure, with either a hand applicator or roller.

### HydroCorner Detail

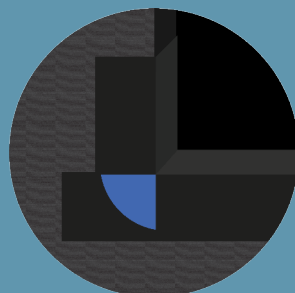

- To use HydroCorners instead of patches, place a HydroCorner in each sill corner and fasten in place with a staple. Install HydroFlash UV+ 9" to extend at least 6 inches up the inside of each jamb inside the window opening.



# UV-PROTECTED RAINSCREEN SYSTEM INSTALLATION INSTRUCTIONS

invisiwrap® sa

hydroflash® uv+

accessories

## INVISIWRAP SA WINDOW ASSEMBLY

### “Fold-In” Window Installation

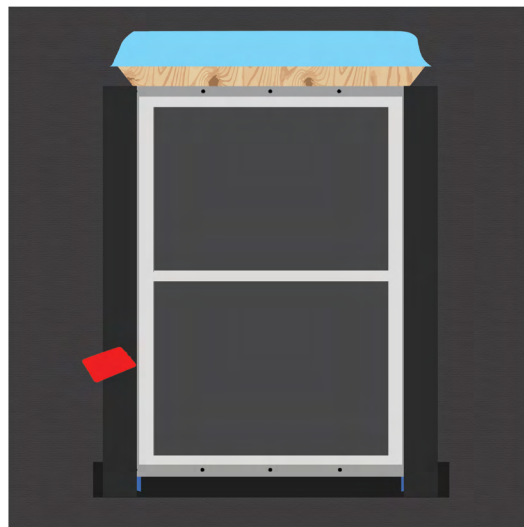
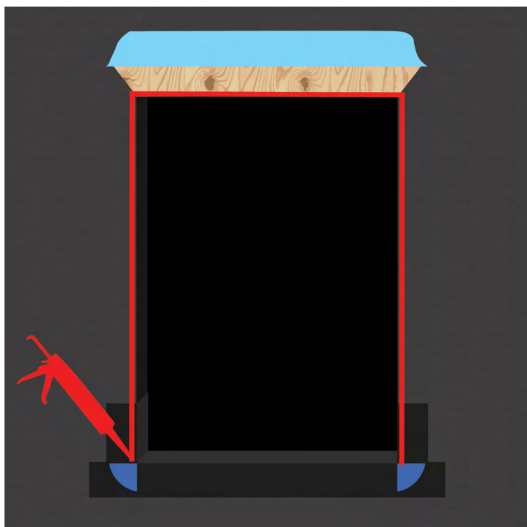

- Apply caulk/sealant at jambs and head. Do not caulk at the window sill.
- Install flanged window. Install HydroFlash UV+ to the side jambs with a hand applicator. Surface should be clean and dry.
- Install drip cap. Apply HydroFlash UV+ header flashing with a hand applicator. Surface should be clean and dry.

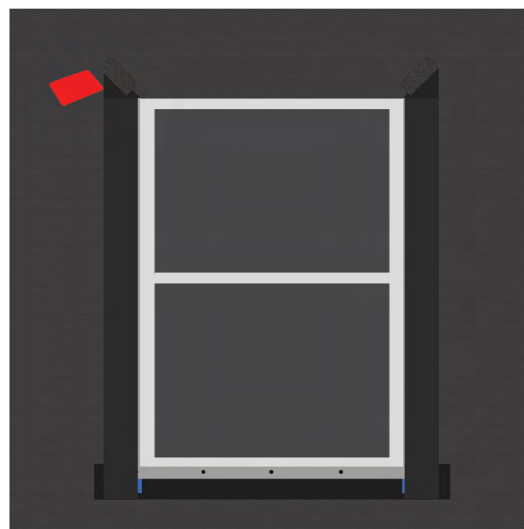
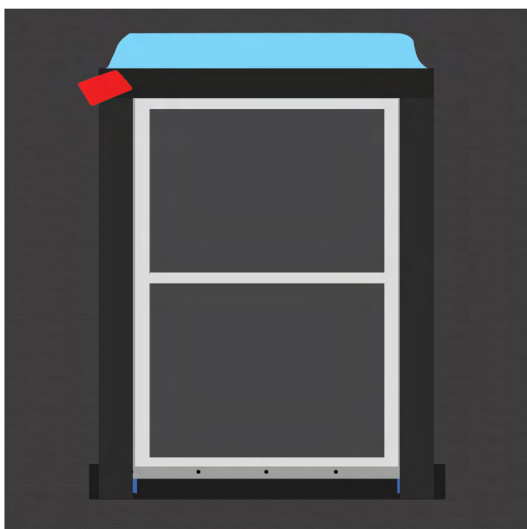

- Fold top flap down removing the adhesive backer. Using a roller or hand applicator, apply pressure to InvisiWrap® SA activating the acrylic adhesive over the head flashing.
- Apply HydroFlash® UV+ at the diagonal relief cuts.