

INVISIWRAP™ UV HOUSEWRAP AND ACCESSORIES

INVISIWRAP™ UV
ENHANCED UV FOR OPEN JOINT CLADDING

BATTEN UV

HYDROFLASH® UV+
ENHANCED ADHESION FOR EXTREME CONDITIONS

Pre-Installation Considerations

- Consider cladding installation requirements, joint spacing, and aesthetics when planning cap placement to attach InvisiWrap UV to sheathing
- Flash wall penetrations (such as outlets, exhaust vents, etc.) with proper shingling technique to maintain drainage to the exterior
- Flash windows and doors according to building code requirements. Surface should be clean and dry. All self-adhered flashing must be adhered using a hand applicator. HydroFlash UV+ should be stored inside or in conditioned space prior to installing in cold temperatures.
- Install windows and doors per manufacturers' installation instructions
- Tape all tears and holes that may have been inadvertently introduced during the construction process
- When installing InvisiWrap UV as the primary air barrier, consider the following:
 - Tape all seams with HydroFlash UV+ 2.3 in. Surface must be clean and dry and tape must be adhered using a hand applicator
 - Seal the bottom of the first course to the foundation or sill plate using approved sealant
 - Tape/seal all penetrations and tears. Surface must be clean and dry and tape must be adhered using a hand applicator
 - Use cap fasteners
- For commercial installation above 40 feet, increase nailing pattern at horizontal and vertical overlaps to every 18 inches. Cap fasteners are also recommended for installation above 40 feet
- To achieve 25 YEAR PRODUCT AND LABOR LIMITED WARRANTY:
 - Install with Benjamin Obdyke Open Joint System protection accessories
 - Cap-fasteners must be used (any brand)
 - Exception: cap-fasteners are not required if they are placed behind furring strips or batten*
 - HydroFlash UV+ must be used as the self-adhered flashing for windows, doors, and other penetrations
 - Taping seams of housewrap is optional, but HydroFlash UV+ (2.3 in. or wider) must be used if seams are taped

Approved Compatible Products for Open Joint Applications

FASTENERS

Staples
Cap Fasteners*

SEAM TAPE

Benjamin Obdyke HydroFlash UV+ 2.3 in. Sealing Tape^
SIGA Wigluv Black

SELF-ADHERED FLASHING

Benjamin Obdyke HydroFlash® UV+*
ZIP System™ Flashing Tape
SIGA Wigluv
SIGA Fentrim F
Nichigo G-Tape™ 3040BK

FLASHING IF EXPOSED TO UV

Benjamin Obdyke HydroFlash® UV+*
SIGA Wigluv Black

BATTENS/FURRING

Benjamin Obdyke Batten UV
Wood furring strips

CAULKS & SEALANTS

OSI® QUAD® MAX Sealant
Loctite® Premium® Construction Adhesive
Loctite® PL Premium® S40 Polyurethane
GeoCel® 2300 Construction Tripolymer
GeoCel® Pro Flex®
Bostik® 915™ Polyurethane Sealant
Bostik® 915FS™ Polyurethane Sealant
Dow Corning® 732 Multi-purpose Sealant
NPC® Solar Seal #900
Titebond® WeatherMaster™
Titebond® WeatherMaster™ ULTIMATE MP
Tremco® Vulkem® 116
DAP® Flexible CLEAR Sealant

*required components to achieve 25 YEAR PRODUCT
AND LABOR LIMITED WARRANTY

^optional components to achieve 25 YEAR PRODUCT
AND LABOR LIMITED WARRANTY

Open Joint Cladding Application: Option 1



Open Joint Cladding Application: Option 2

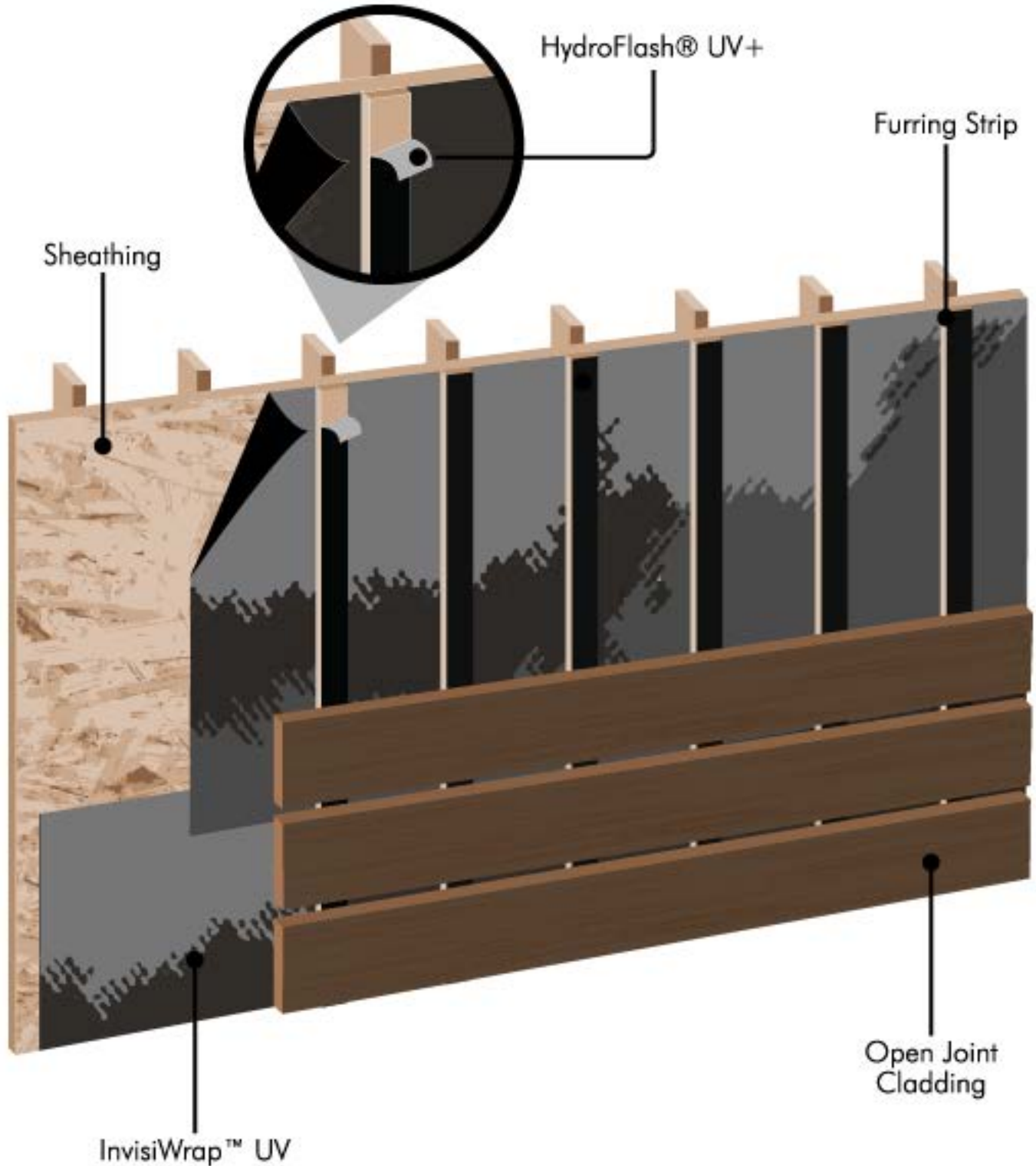

Basic Installation & Window Flashing: "Fold-In" Method

Step 1

- Unroll InvisiWrap UV with black/glossy side facing out and fasten to sheathing with nails, staples, or cap fasteners.
- Fasteners should provide a minimum of 1/2 inch penetration into the nail base and be spaced approximately 12 to 18 inches apart along the horizontal and vertical laps. Fasten every 3 ft elsewhere. ****For commercial installation above 40 feet, cap fasteners are recommended. Consider cladding installation requirements and joint width to plan coverage of fasteners.**
- InvisiWrap UV should be installed shingle lap fashion (ie. begin installation at the base of the wall assembly).
- Extend the housewrap a minimum 2 inches over sill plate.
- Overlap all horizontal seams by at least 4 inches, all vertical seams by at least 6 inches and corners by 12 inches.
- Be sure that the housewrap installation and flashing provide for positive drainage to the exterior of the assembly.
- Do not allow the housewrap to be exposed to sunlight in excess of 365 days prior to the installation of cladding.
- Taping of seams is NOT REQUIRED. Optionally, tape all InvisiWrap UV seams with HydroFlash UV+ 2.3 inch. Surface must be clean and dry, and tape must be adhered using a hand applicator.

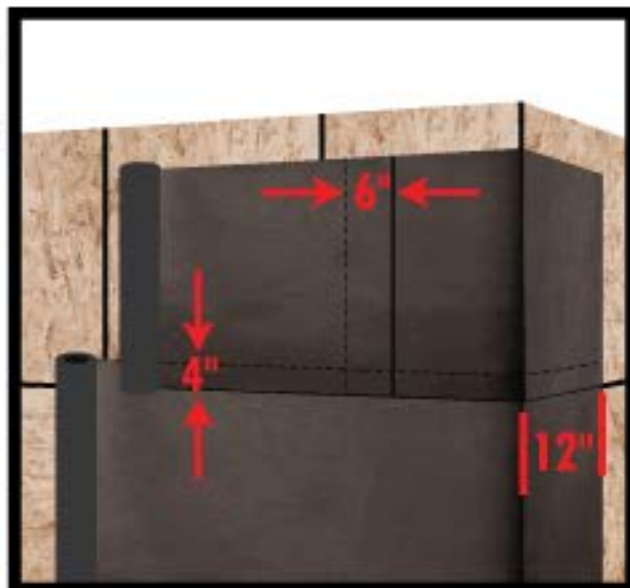

Step 2

- Wrap the entire building including window and door openings.
- At each opening, cut an "I". Cut housewrap at the head 45 degrees away from window opening to account for flashing width.
- Fold up top trapezoid shaped "flap" and secure it temporarily with tape prior to installing window.
- Fold side flaps into rough opening and cut/fasten.
- Install 6 inch HydroFlash UV+ flush with the window sill, and 6 inches past the rough opening.

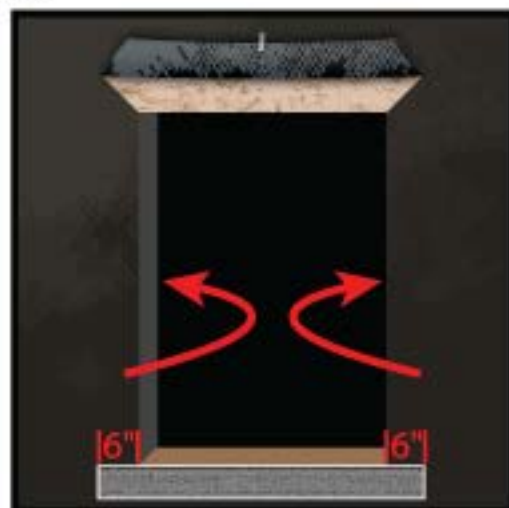
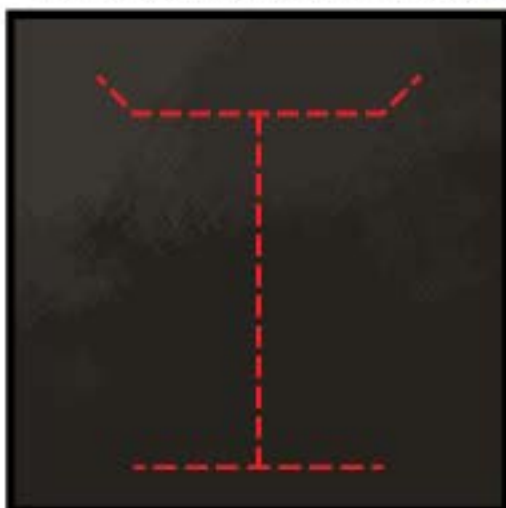

Basic Installation & Window Flashing: Method 1

Bow Tie Detail

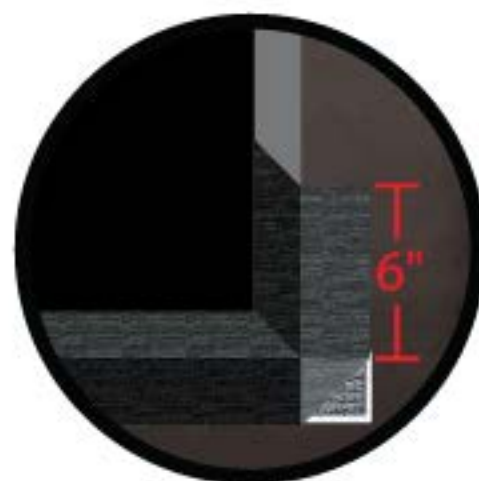
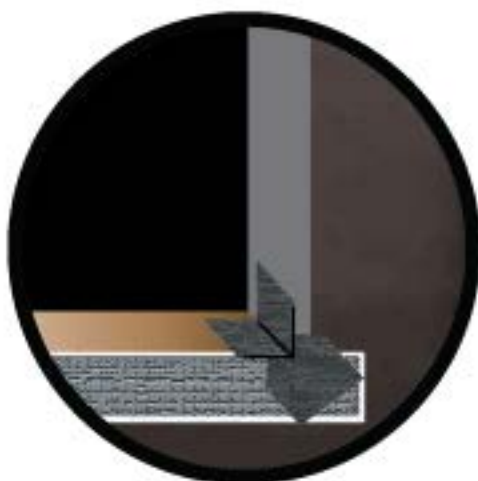
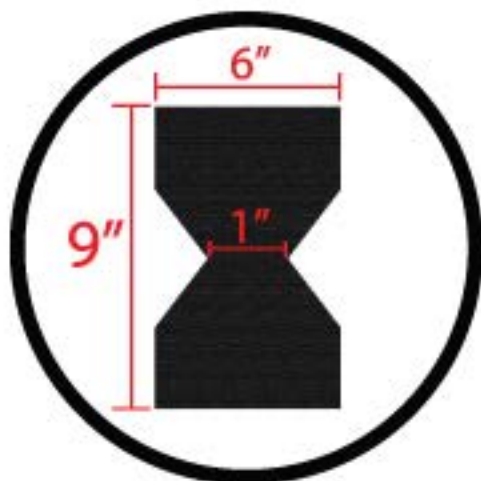

- (Optional) Install sloped sill or back dam (optimal slope 1/4 inch), except when using approved pre-manufactured sill pan.
- To use 6 in wide HydroFlash UV+ at the sill, you must use two pieces: one piece flush with the edge of the sill; one piece folded into sill. 4 inch wide self adhered flashing is not recommended for sill treatment.
- To properly flash the sill, cut and install corner patch flashing or use HydroCorners.
- Install HydroFlash UV+ to extend at least 6 inches up the side of each jamb inside window opening.

Basic Installation & Window Flashing: "Fold-In" Method
HydroCorner Detail

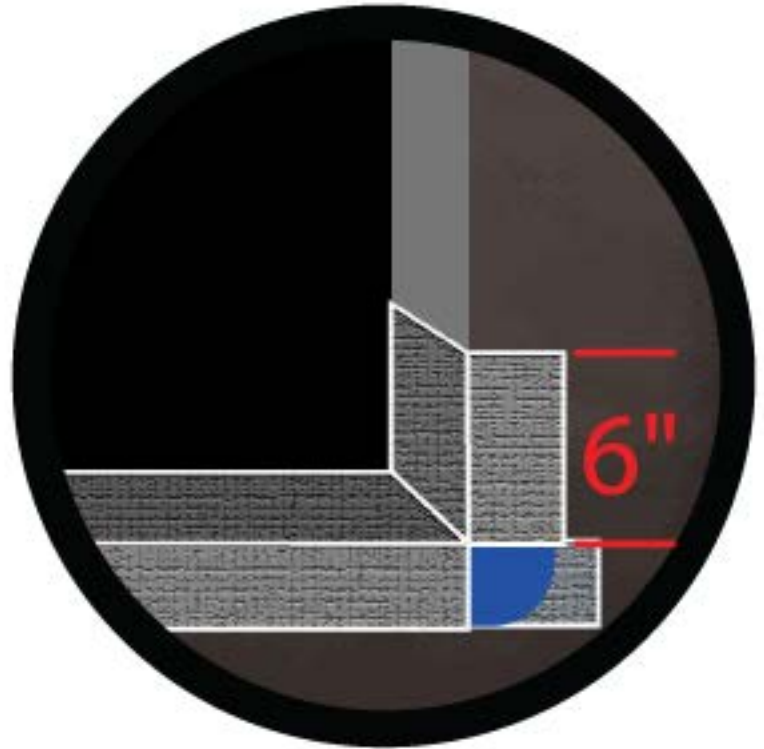
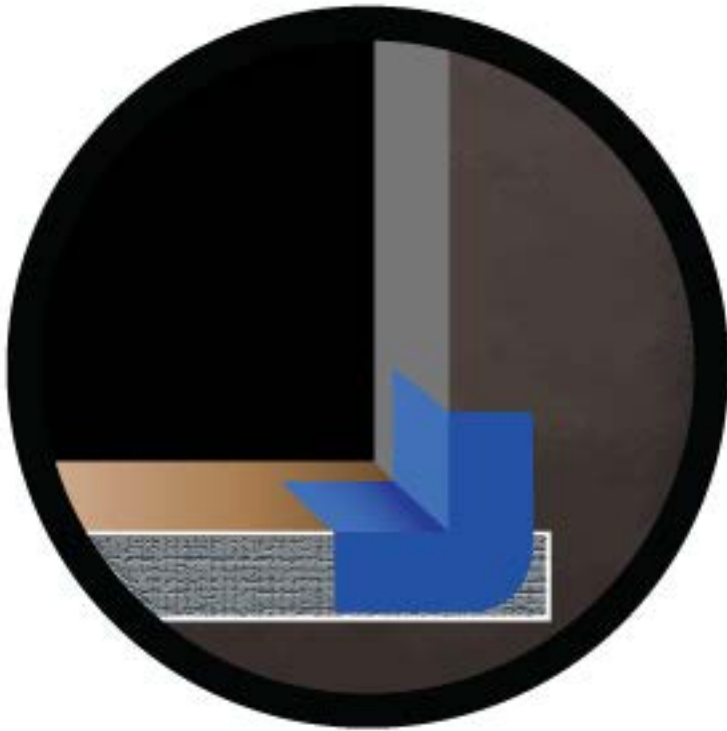

- To use HydroCorners instead of corner patches, place a HydroCorner in each sill corner and fasten in place with a staple. Install HydroFlash UV+ to extend at least 6 inches up the inside of each jamb inside window opening.

Basic Installation & Window Flashing: "Fold-In" Method

Step 3

- Apply caulk/sealant at jambs and head.
- Install flanged window.
- Install HydroFlash UV+ to the jambs. Surface should be clean and dry, and self-adhered flashing should be applied using a hand applicator.



- Install drip cap. Install HydroFlash UV+ header flashing. Surface should be clean and dry, and self-adhered flashing should be adhered with a hand applicator.
- Fold top flap down on top of flashed header and apply HydroFlash UV+ at diagonal cuts.

